

REVISIONS				
ZONE	REV.	DESCRIPTION	DATE	APPROVED

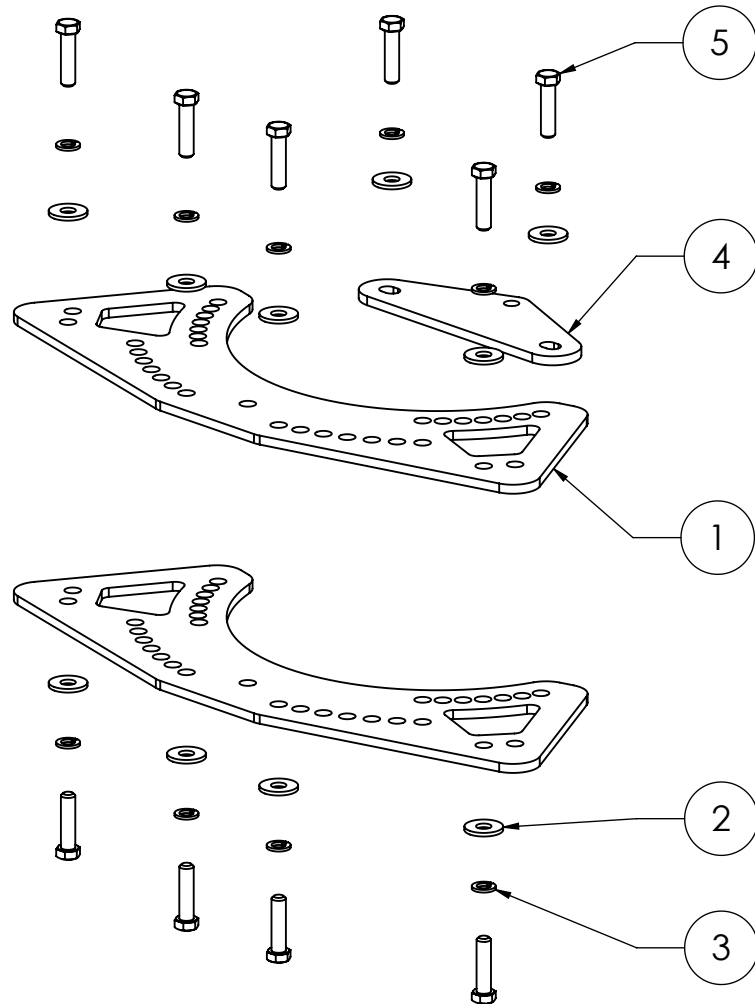

**WARNING:** Connection of Cabinets to Array Frame must be symmetric

**WARNING:** Connection of each Cabinet to Array Frame Must be made with at least 2 Points

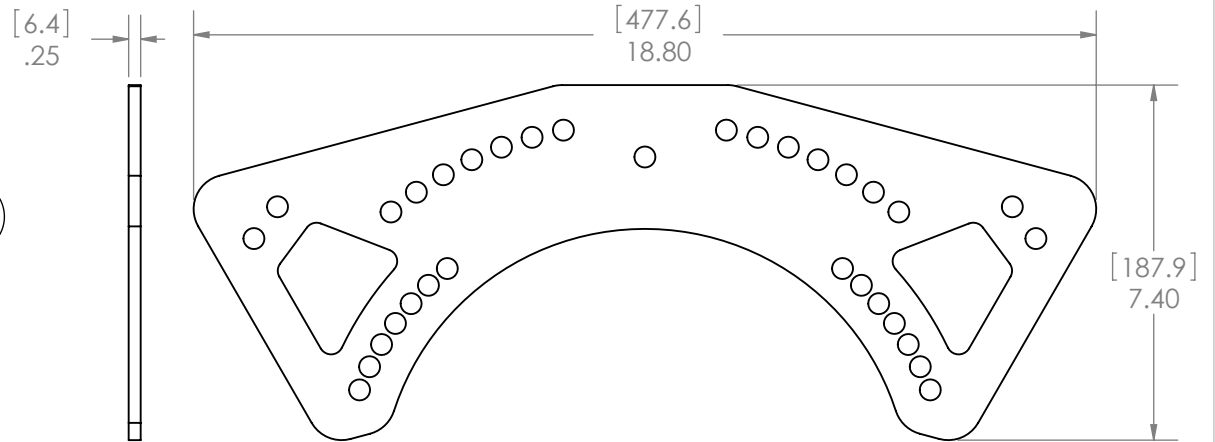

Connect to rear of cabinets once connections to main array frames have been made.

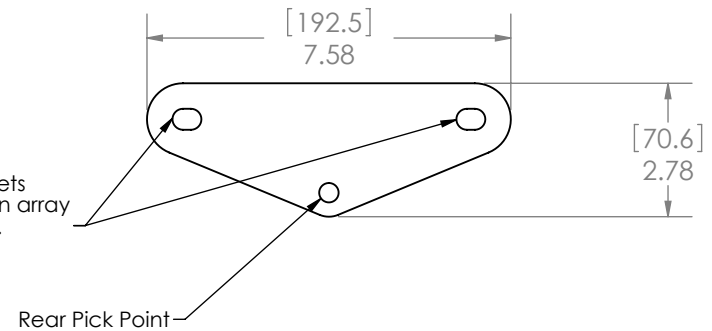

ITEM NO.	PART NUMBER	QTY.
1	901-3015	2
2	3-8 Flat Washer PFC9 Yellow Zinc	10
3	3-8 Lock Washer PFC9 Yellow Zinc	10
4	901-3025	1
5	3-8-16 X 1500 Grade 8 Hex Hd Cap Screw Yellow Zinc	10

**PROPRIETARY AND CONFIDENTIAL**  
THE INFORMATION CONTAINED IN THIS DRAWING IS THE SOLE PROPERTY OF McCauley Sound Inc. ANY REPRODUCTION IN PART OR AS A WHOLE WITHOUT THE WRITTEN PERMISSION OF McCauley Sound Inc. IS PROHIBITED.

NAME	DATE
DRAWN RM	072806
DIMENSIONS ARE IN INCHES TOLERANCES: $\pm 0.01$ ANGULAR: $\pm 0.1$ BEND $\pm 0.1$	
FINISH Blk/Wht Powder Coat	
Additional Accessories Eye Bolts, Swivel Hoist Rings	
DRAWING NOT TO SCALE	

**McCauley Sound Inc.**

16607 Meridian Ave E  
Puyallup, WA 98375  
(ph 253-848-0363) (fax 253-841-3050)

SIZE **A** Project Name: IDB.88-AF Installation Kit REV. 1

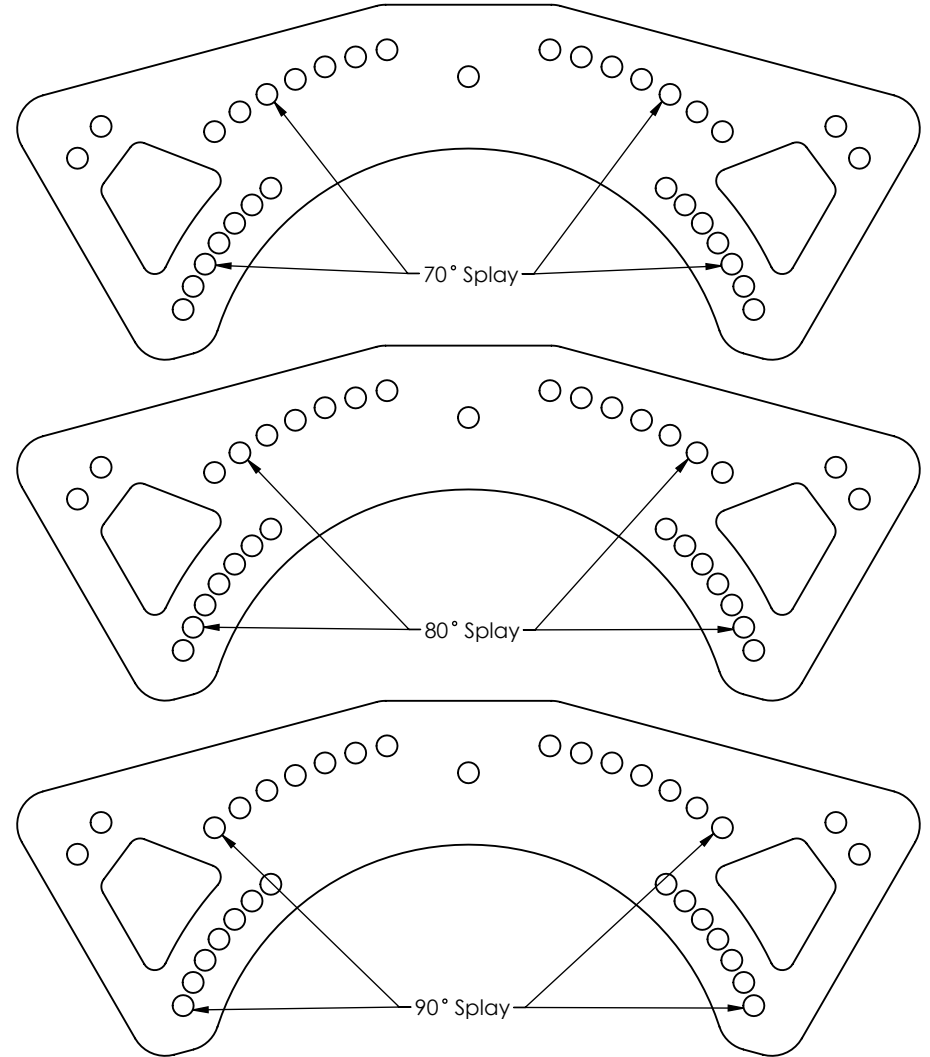
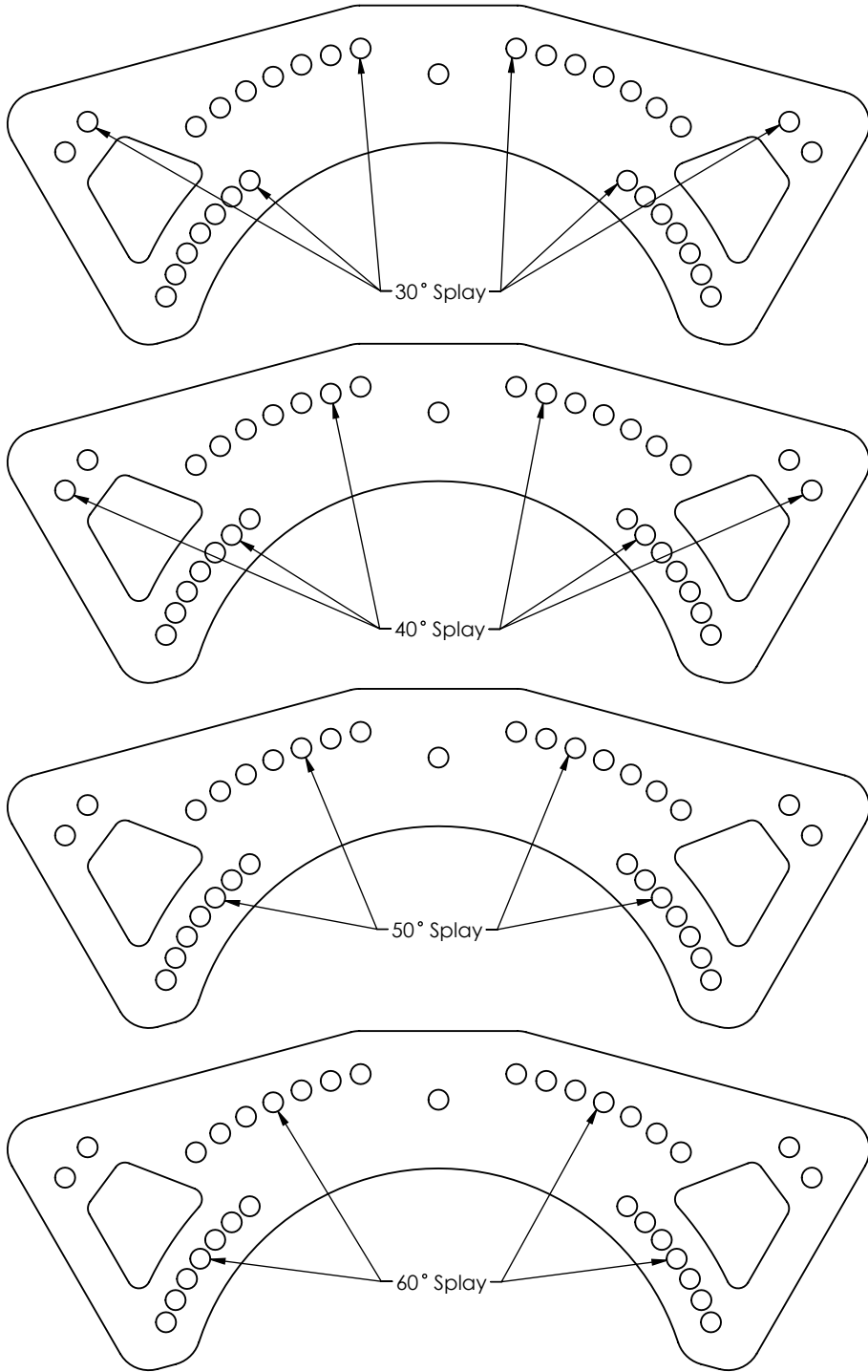

		REVISIONS			
ZONE	REV.	DESCRIPTION		DATE	APPROVED

**PROPRIETARY AND CONFIDENTIAL**  
THE INFORMATION CONTAINED IN THIS  
DRAWING IS THE SOLE PROPERTY OF  
McCauley Sound Inc. ANY  
REPRODUCTION IN PART OR AS A WHOLE  
WITHOUT THE WRITTEN PERMISSION OF  
McCauley Sound Inc. IS PROHIBITED.

	NAME	DATE
DRAWN	RM	072806
DIMENSIONS ARE IN INCHES TOLERANCES: ±0.01 ANGULAR: ±0.1 BEND ±0.1		
FINISH	Blk/Wht Powder Coat	
Additional Accessories		
LE	Eye Bolts, Swivel Hoist Rings	
DRAWING NOT TO SCALE		

## McCauley Sound Inc.

16607 Meridian Ave E  
Puyallup, WA 98375  
(ph 253-848-0363) (fax 253-841-3050)

SIZE	Project Name:	REV.
A	IDB.88-AF Installation Kit	1